

COLUMBIA UNIVERSITY  
IN THE CITY OF NEW YORK  
COLUMBIA UNIVERSITY FACILITIES

MEMORANDUM

TO: RESIDENTS OF 410 RIVERSIDE DRIVE  
FROM: Sunny Kim  
Project Manager  
DATE: October 4, 2021  
RE: **FAÇADE REPAIRS—SCHEDULED WORK FOR THE WEEK OF OCTOBER 4**

---

Please be advised of planned work for the week of October 4.

**Riverside Dr & W113th St Elevations – Dormer waterproofing**

Waterproofing membrane will be installed at roof dormers facing both street elevations. Work is mostly quiet.

**Riverside Dr Elevation – Joint pointing**

Brick and stone joints around units 31 41 61 71 81 91 and 101 facing Riverside Dr. Work is mostly quiet.

**Riverside Dr & W113th St Elevations –Terra cotta & Brick removal**

Removal of terra cotta and damaged brick will continue at units 72 82 92 and 122 facing Riverside Drive and at units 123 and 133 facing West 113<sup>th</sup> St. Work will create intermittent jackhammering and dust.

**Riverside Dr & W113th St Elevations – Brick joint cutting and pointing**

Brick joints will be cut and then pointed at 2-line and 3-line from 6<sup>th</sup> floor to 10<sup>th</sup> floor facing both street elevations. This work will create grinding noise and dust for the first few days then mostly quiet.

**Contacts and communication**

If you have any questions or concerns about this project, please contact Nelson Falcon, Director for Residential Services, at [nf36@columbia.edu](mailto:nf36@columbia.edu). Thank you for your understanding during these challenging circumstances.

# 410 Riverside Drive LL11 Facade Repairs

Oct 4-8

Work Scope:

Legend

Copper dormer waterproofing  
(Mostly quiet)



Pointing  
(Mostly quiet)



Terra cotta & Brick removal  
(Intermittent jackhammering & dust)



Joint cutting & pointing  
(Grinding noise & dust then mostly quiet)

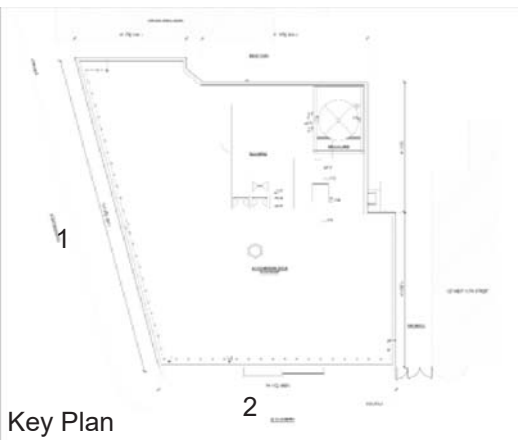
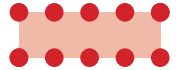

Key Plan

2

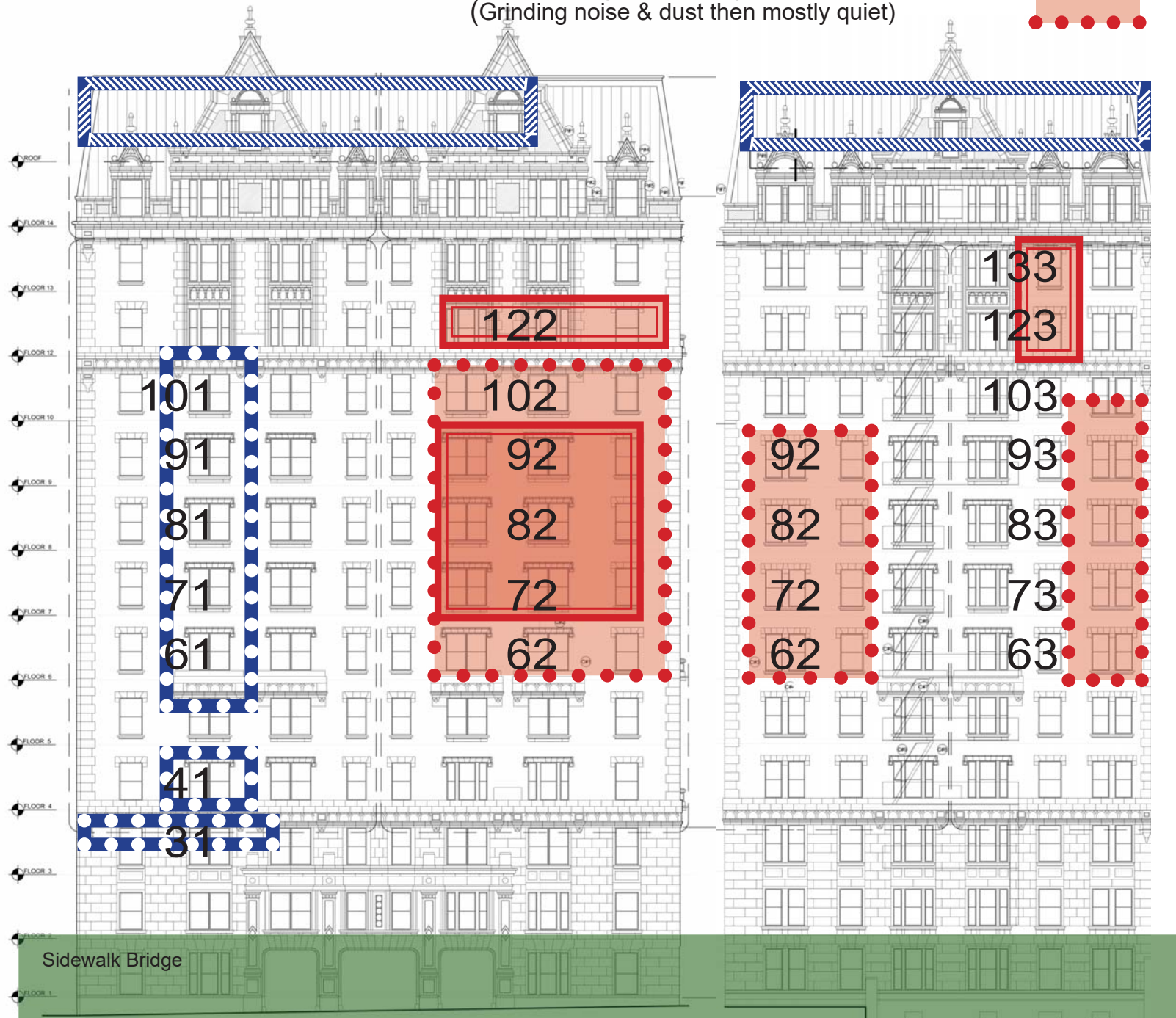

1 Riverside Dr. Elevation

2 W113 St. Elevation